



EMERALD
— AVENTURA —

•BOUTIQUE OFFICE SUITES•

— COMING SOON TO —
AVENTURA
FLORIDA, USA

Premium Class A offices
starting at \$300k





EMERALD

• A TRUE JEWEL •

Located in the Aventura area, very close to Miami Gardens Drive and Biscayne Blvd, as well as the celebrated Aventura Shopping Mall. EMERALD is strategically positioned to be an ideal workplace for thriving companies and entrepreneurs.

In the last decade, the Miami area, especially the city of Aventura has witnessed an exponential growth of prosperous businesses. This kind of momentum turns EMERALD into a solid investment opportunity and an ideal work environment.

With its state of the art design, and convenient exposure to Biscayne Blvd, there is no doubt that EMERALD is certain to become an icon of the Aventura vicinity.

ARTIST RENDERING. SEE LEGAL DISCLAIMER

UNIQUE DESIGN

EMERALD has been designed by the world renowned architecture firm **OPPENHEIM ARCHITECTURE + DESIGN**, headquartered in Miami with offices in New York and Switzerland. The firm was founded by Chad Oppenheim, who along with his outstanding team of professionals, has designed highly awarded innovative projects around the globe. The Firm has achieved over 70 career distinctions, including more than 45 AIA Awards.

Oppenheim's project highlights include Ten Museum Park Tower, The Elegant 50-story luxury condo development in downtown Miami, and Net Metropolis Commercial Complex, the 1.6 million square foot multitower in Manila, Philippines. The latter is the nation's first sustainable design program developed in concert with the U.S. Green Building Council.

Oppenheim's commitment to green architecture has made him a highly sought-after global lecturer and adjunct professor at the Harvard Graduate School of Design.

The EMERALD design team was led by Chad Oppenheim and Juan Calvo, VP of Design, who were able to transform their ideas and concepts into a wonderful, creative and groundbreaking project.



FANTASTIC LOCATION

- | | | |
|---|---------------------|---------------------|
| 1. Ives Dairy Rd | 4. West Dixie Hwy | 7. Williams Islands |
| 2. Aventura Mall | 5. Biscayne Blvd | 8. Sunny Isles |
| 3. Town Center Aventura
(Lohemann's Plaza) | 6. Miami Gardens Dr | |



A NEW ICON IN THE AVENTURA AREA

ARTIST RENDERING, SEE LEGAL DISCLAIMER





AN IDEAL WORK
ENVIRONMENT

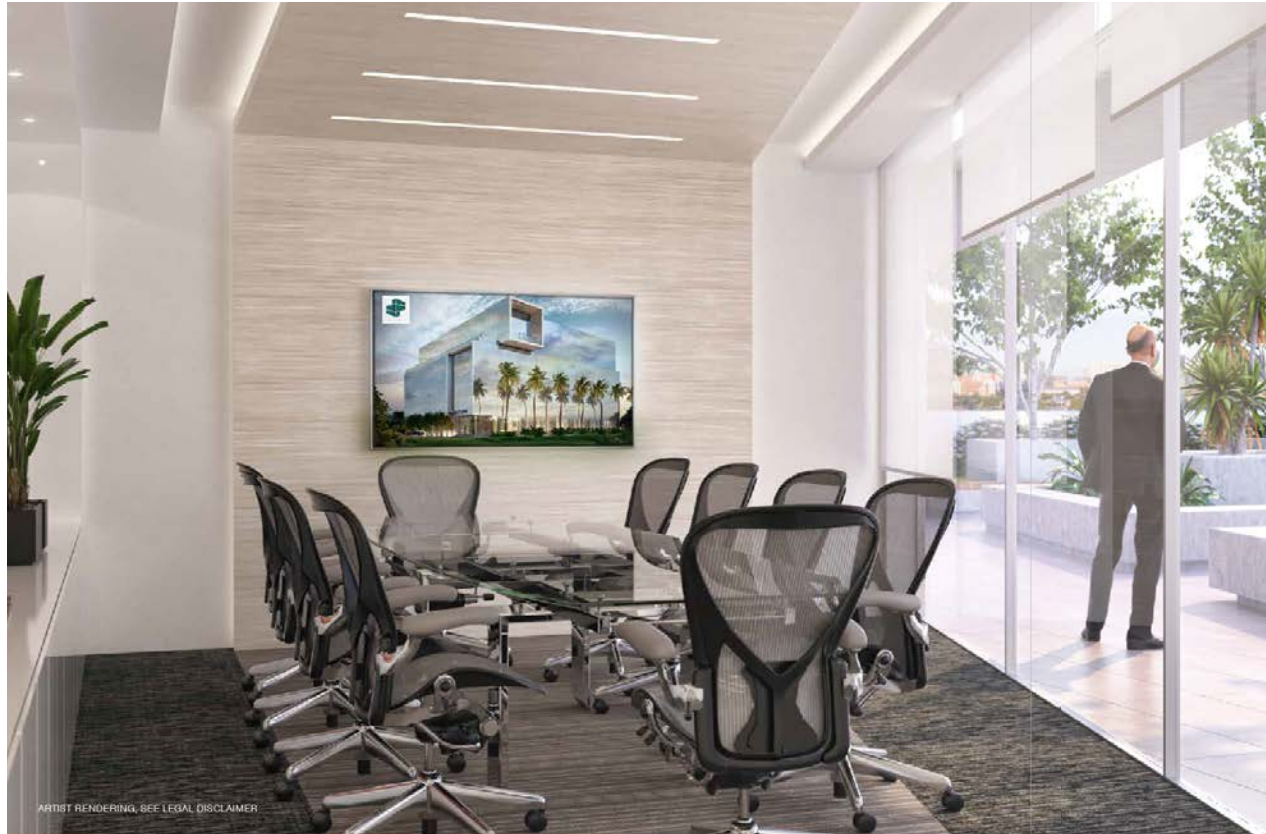

FEATURES & AMENITIES

- Premium location, walking distance from Miami Gardens Drive and Biscayne Blvd, and quick access to the I-95
- Conveniently surrounded by banks, restaurants, recreational areas, shops, and hotels
- Unique architectural design
- The most innovative and unique glass facade system, giving EMERALD an exclusive look, with the value and distinction that a precious jewel deserves
- 6 comfortable and exclusive conference rooms one on each office level
- The Emerald Terrace, a green rooftop with space for business meetings and leisure to share with your guests
- Cutting edge technology
- Convenient parking with direct access to each level





ARTIST RENDERING. SEE LEGAL DISCLAIMER

SECURITY,
LUXURY & COMFORT

ARTIST RENDERING, SEE LEGAL DISCLAIMER



PREMIUM • OFFICE SPACES

EMERALD reflects a modern & functional design
with versatile office spaces ranging between:

600 ft² & 1200ft²

A PERFECT FIT FOR YOUR NEEDS

• EMERALD TERRACE •
YOUR OWN PRIVATE GARDEN

ARTIST RENDERING, SEE LEGAL DISCLAIMER



GROUND LEVEL



LEVEL 05

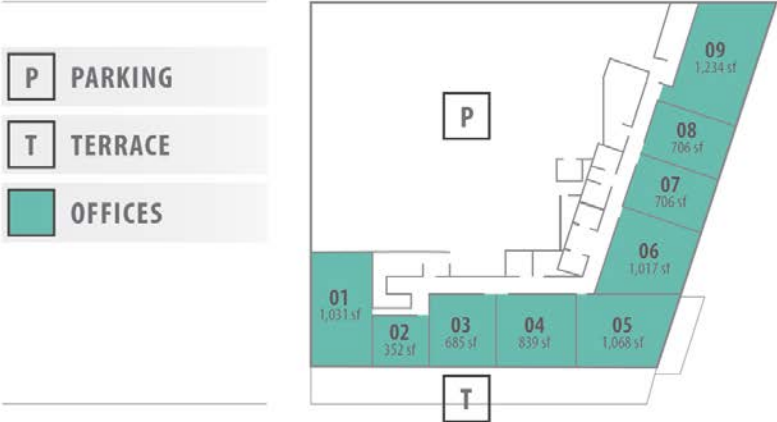

LEVEL 02 - 04

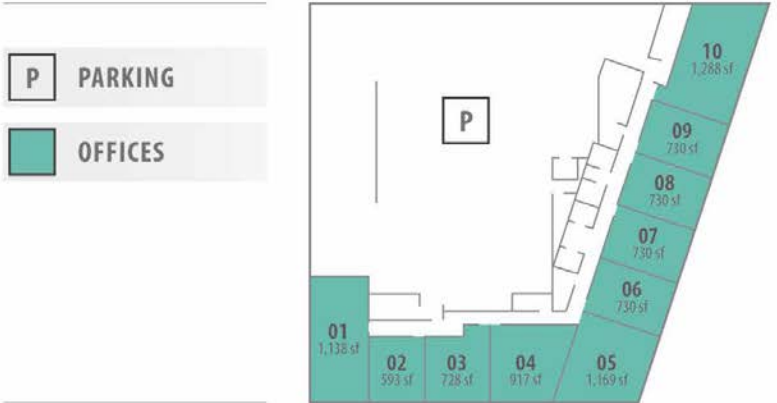

LEVEL 06

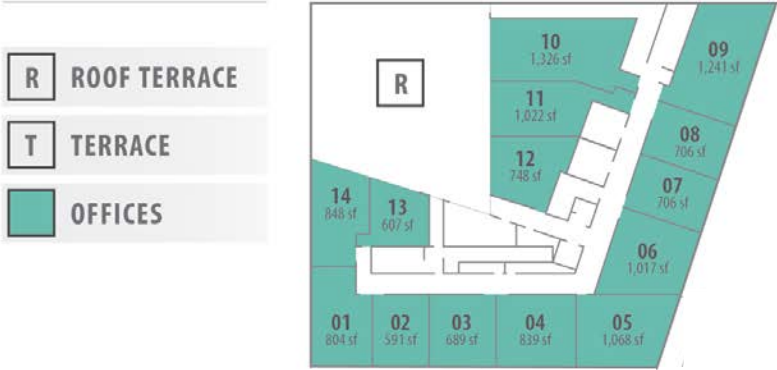

All Areas are Gross measured based on BOMA Standard. Prices in Shell Condition. Optional Buildout.

CLASS A OFFICE BUILDING

Excellent investment
opportunity, attractive
purchase prices letting you
diversify your portfolio.



ARTIST RENDERING, SEE LEGAL DISCLAIMER



Site Location: 2655 NE 186th Terrace, Miami, FL 33180, USA

www.emeraldaventura.com

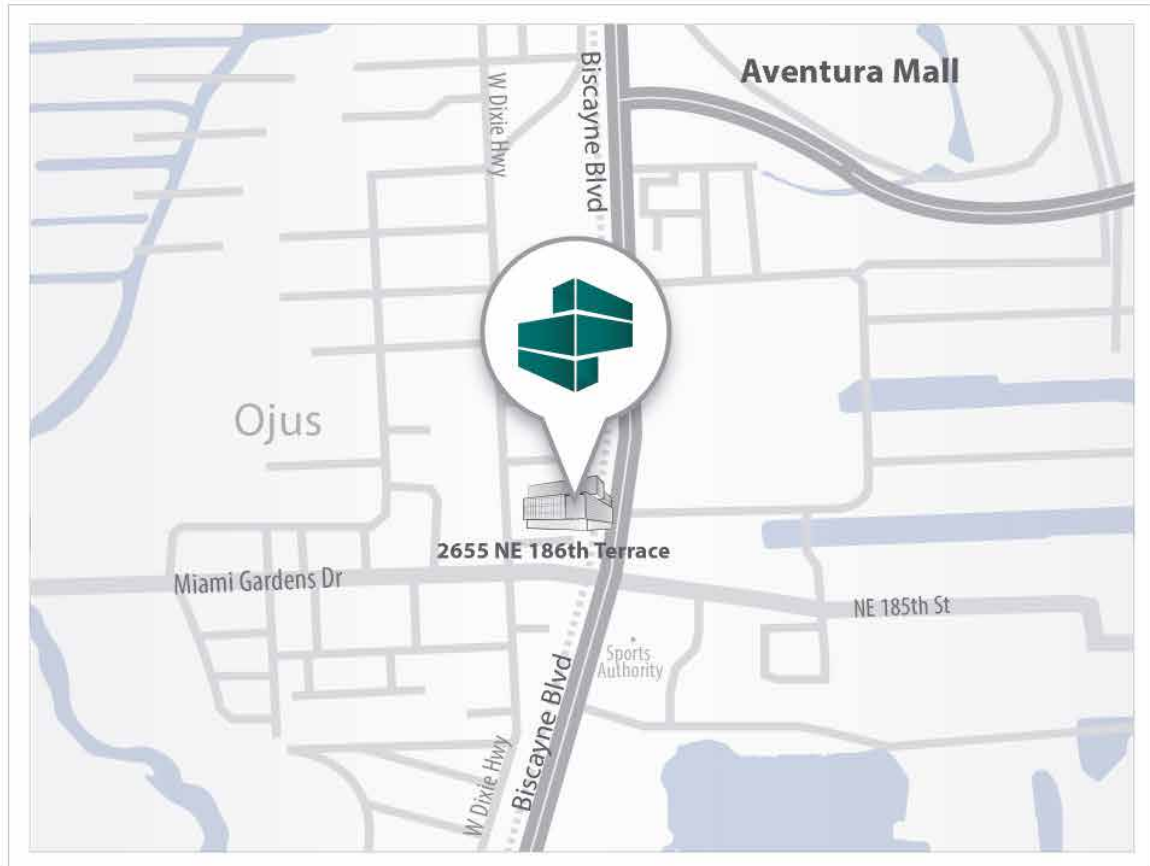

Our Team:

**OPPENHEIM
ARCHITECTURE**



PREMIUM
DEVELOPERS GROUP LLC

This advertisement does not constitute an offer to sell or a solicitation of an offer to buy a unit in EMERALD, a Condominium (the "Condominium"). No solicitation, offer or sale of a unit in the Condominium will be made in any state or country in which such activity would be unlawful prior to any required registration in such jurisdiction. All renderings, sketches, graphic materials, plans, specifications, terms, prices, conditions, statements, features, dimensions, amenities, existing or future views and photos or images depicted, or otherwise described, herein are proposed and conceptual only, and are based upon preliminary development plans, which are subject to withdrawal, revisions and other changes, without notice. No guarantees or representations whatsoever are made that the features, amenities and facilities, and existing or future views of the project and surrounding areas, depicted by these artist's renderings or otherwise described herein, will be provided, or, if provided, will be of the same type, size, location or nature as depicted or described herein. The Condominium is being developed by 2655 Developers LLC, a Florida Limited Liability company (the "Developer"), which was formed solely for such purpose. The Developer has a limited right to use the names and logos of Premium Developers Group, LLC, a Florida limited liability company pursuant to license and marketing agreements with such entities. Any and all statements, disclosures and/or representations shall be deemed made by Developer and not by any other party, and you agree to look solely to the Developer (and not to any other party) with respect to any and all matters relating to the marketing and/or development of the Condominium and with respect to the sales of units in the Condominium.